

# Industrial / Flex Availability

339 East Maple Street, North Canton, OH

The Hoover District is located within minutes of I-77 and the Akron Canton Airport on the corner of Main Street and East Maple in the heart of Downtown North Canton, OH. The historic property sits on 88 acres and encompasses 1.4 million square feet.



Michelle Nicholson  
440.539.3545 | [mnicholson@icpllc.com](mailto:mnicholson@icpllc.com)



## Property Facts

**Total Available** 300,211 SF

**1st Floor SF** 188,748

**2nd Floor SF** 111,463

**Surface Parking** 907 free of charge

**Elevators** One (1) passenger elevator Capability for two (2) if needed AT&T and Spectrum

**Signage** Façade signage available

**Fiber Optics** Connection is available at building Area served by two (2) circuits (AT&T and Spectrum)

**Electricity** Tenants are separately metered and billed for electricity consumed through, lights, outlets and HVAC.

**Security** Key card access to building suite. Suburban building with a nightly and weekend (24 hours /365 days) manned security station.

**Sprinklered** Fully sprinklered with flow, pressure and valve tamper alarms. Smoke and fire alarms



# Aerial



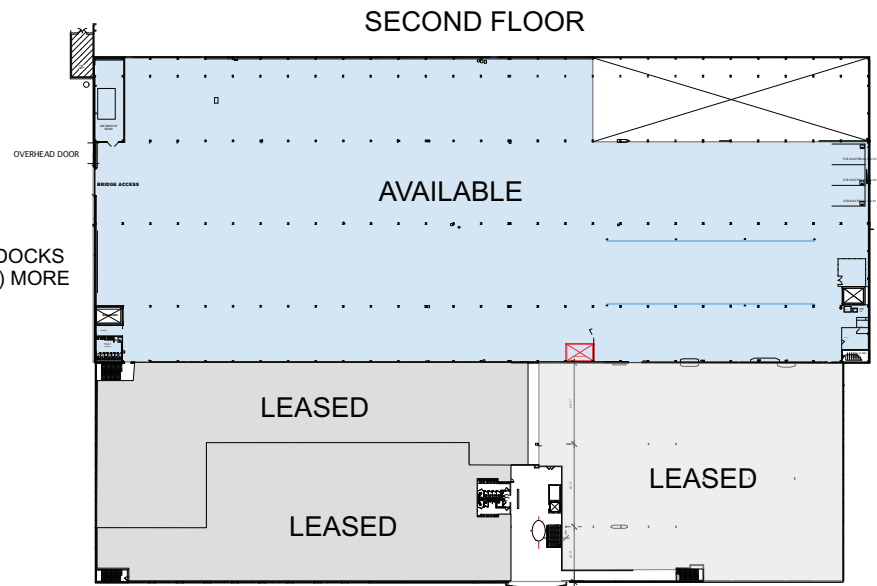
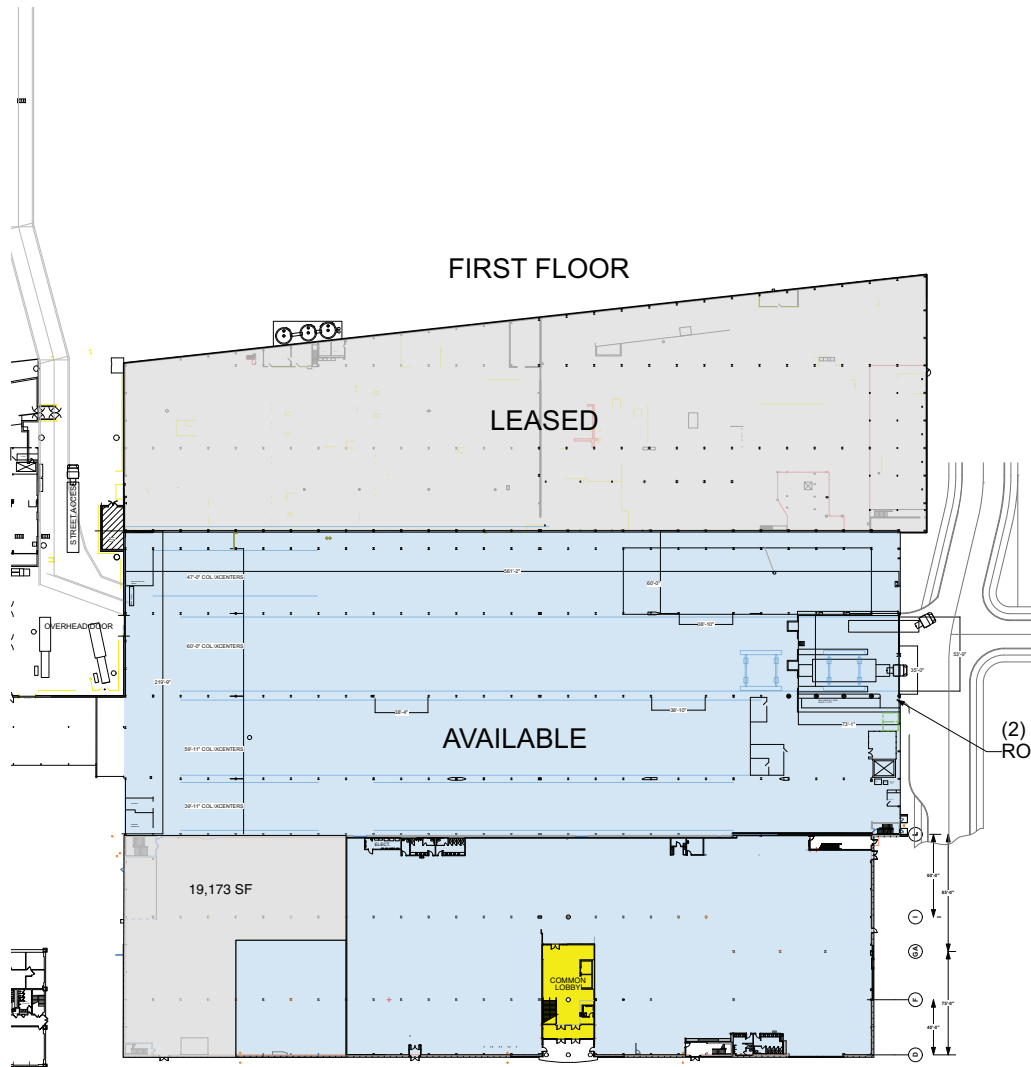

TOTAL AVAILABLE  
300,211 SF